

PLEASE NOTE: The prices below are for reference only and are base models constructed of HPL work surfaces, TFL cabinets and doors with standard pulls, standard hinges and without locks. For detailed pricing please contact your local dealer or **mediatechnologies®**.

Rectangular Worksurface (WS)

Model Number	Description	Wgt.	List Price
WS-C-2030	20"D x 30"W	18	\$205
WS-C-2036	20"D x 36"W	28	\$242
WS-C-2042	20"D x 42"W	25	\$245
WS-C-2048	20"D x 48"W	35	\$264
WS-C-2060	20"D x 60"W	45	\$320
WS-C-2072	20"D x 72"W	49	\$362
WS-C-2084	20"D x 84"W	55	\$416
WS-C-2096	20"D x 96"W	74	\$458
WS-C-20120	20"D x 120"W	84	\$542
WS-C-20144	20"D x 144"W	99	\$621
WS-C-2430	24"D x 30"W	21	\$224
WS-C-2436	24"D x 36"W	29	\$248
WS-C-2442	24"D x 42"W	33	\$271
WS-C-2448	24"D x 48"W	43	\$297
WS-C-2460	24"D x 60"W	50	\$360
WS-C-2472	24"D x 72"W	59	\$409
WS-C-2484	24"D x 84"W	66	\$469
WS-C-2496	24"D x 96"W	74	\$518
WS-C-24120	24"D x 120"W	101	\$615
WS-C-24144	24"D x 144"W	115	\$711
WS-C-3036	30"D x 36"W	37	\$283
WS-C-3042	30"D x 42"W	45	\$313
WS-C-3048	30"D x 48"W	55	\$342
WS-C-3060	30"D x 60"W	58	\$414
WS-C-3072	30"D x 72"W	65	\$474
WS-C-3084	30"D x 84"W	74	\$547
WS-C-3096	30"D x 96"W	99	\$608
WS-C-30120	30"D x 120"W	126	\$722
WS-C-30144	30"D x 144"W	132	\$841
WS-C-3630	36"D x 30"W	32	\$283
WS-C-3642	36"D x 42"W	44	\$355
WS-C-3648	36"D x 48"W	50	\$387
WS-C-3660	36"D x 60"W	63	\$472
WS-C-3672	36"D x 72"W	76	\$542
WS-C-3684	36"D x 84"W	88	\$624
WS-C-3696	36"D x 96"W	101	\$694
WS-C-36120	36"D x 120"W	126	\$834
WS-C-36144	36"D x 144"W	151	\$971

Corner Worksurface with Radius Edge (WSCR)

Model Number	Description	Wgt.	List Price
WSRS-C-42/2424	42"Square/24"Right x 24"Left	51	\$739
WSRS-C-42/3024	42"Square/30"Right x 24"Left	51	\$739
WSRS-C-42/2430	42"Square/24"Right x 30"Left	51	\$739
WSRS-C-42/3030	42"Square/30"Right x 30"Left	51	\$739
WSRS-C-48/2424	48"Square/24"Right x 24"Left	67	\$824
WSRS-C-48/3024	48"Square/30"Right x 24"Left	67	\$824
WSRS-C-48/2430	48"Square/24"Right x 30"Left	67	\$824
WSRS-C-48/3030	48"Square/30"Right x 30"Left	67	\$824

Square Worksurface (WS)

Model Number	Description	Wgt.	List Price
WS-C-3030	30"D x 30"W	21	\$456
WS-C-3636	36"D x 36"W	38	\$520
WS-C-4242	42"D x 42"W	51	\$596
WS-C-4848	48"D x 48"W	67	\$683

Conference Corner - Left Handed (WSCCL)

Model Number	Description	Wgt.	List Price
WSCCSL-C-2066	48"L x 66"W x 20"D return	92	\$996
WSCCSL-C-2466	48"L x 66"D x 24"D return	92	\$996
WSCCSL-C-3066	48"L x 66"D x 30"D return	92	\$996
WSCCSL-C-2072	48"L x 72"W x 20"D return	101	\$1,048
WSCCSL-C-2472	48"L x 72"D x 24"D return	101	\$1,048
WSCCSL-C-3072	48"L x 72"D x 30"D return	101	\$1,048
WSCCSL-C-2084	48"L x 84"W x 20"D return	118	\$1,169
WSCCSL-C-2484	48"L x 84"D x 24"D return	118	\$1,169
WSCCSL-C-3084	48"L x 84"D x 30"D return	118	\$1,169

Corner Worksurface with Straight Edge (WSCS)

Model Number	Description	Wgt.	List Price
WSCS-C-42/2424	42"Square/24"Right x 24"Left	51	\$700
WSCS-C-42/3024	42"Square/30"Right x 24"Left	51	\$700
WSCS-C-42/2430	42"Square/24"Right x 30"Left	51	\$700
WSCS-C-42/3030	42"Square/30"Right x 30"Left	51	\$700
WSCS-C-48/2424	48"Square/24"Right x 24"Left	67	\$788
WSCS-C-48/3024	48"Square/30"Right x 24"Left	67	\$788
WSCS-C-48/2430	48"Square/24"Right x 30"Left	67	\$788
WSCS-C-48/3030	48"Square/30"Right x 30"Left	67	\$788

Conference Corner - Right Handed (WSCCR)

Model Number	Description	Wgt.	List Price
WSCCSR-C-2066	48"L x 66"W x 20"D return	92	\$996
WSCCSR-C-2466	48"L x 66"D x 24"D return	92	\$996
WSCCSR-C-3066	48"L x 66"D x 30"D return	92	\$996
WSCCSR-C-2072	48"L x 72"W x 20"D return	101	\$1,048
WSCCSR-C-2472	48"L x 72"D x 24"D return	101	\$1,048
WSCCSR-C-3072	48"L x 72"D x 30"D return	101	\$1,048
WSCCSR-C-2084	48"L x 84"W x 20"D return	118	\$1,169
WSCCSR-C-2484	48"L x 84"D x 24"D return	118	\$1,169
WSCCSR-C-3084	48"L x 84"D x 30"D return	118	\$1,169

Worksurface description

- 1.25" 45lb. density particle board core
- High pressure laminate top
- 3mm PVC edge

P-EWORKSPACEWORKSURFACE-230101

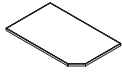

Worksurface with Nipped Left Corner (WSNL)			
Model Number	Description	Wgt.	List Price
WSNL-C-3030	30"D x 30"W	21	\$253
WSNL-C-3036	30"D x 36"W	32	\$389
WSNL-C-3042	30"D x 42"W	37	\$420
WSNL-C-3048	30"D x 48"W	42	\$449
WSNL-C-3060	30"D x 60"W	53	\$521
WSNL-C-3072	30"D x 72"W	63	\$581
WSNL-C-3084	30"D x 84"W	74	\$655
WSNL-C-3096	30"D x 96"W	84	\$714

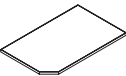

Worksurface with Nipped Right Corner (WSNR)			
Model Number	Description	Wgt.	List Price
WSNR-C-3030	30"D x 30"W	21	\$253
WSNR-C-3036	30"D x 36"W	32	\$389
WSNR-C-3042	30"D x 42"W	37	\$420
WSNR-C-3048	30"D x 48"W	42	\$449
WSNR-C-3060	30"D x 60"W	53	\$521
WSNR-C-3072	30"D x 72"W	63	\$581
WSNR-C-3084	30"D x 84"W	74	\$655
WSNR-C-3096	30"D x 96"W	84	\$714



Round Worksurface (WS)			
Model Number	Description	Wgt.	List Price
WS-C-0036	36"Diameter	30	\$665
WS-C-0042	42"Diameter	40	\$739
WS-C-0048	48"Diameter	53	\$824



P-Top with Left Return (WSPL)			
Model Number	Description	Wgt.	List Price
WSPL-C-3072	72"W x 30"D x 42" dia. Return	101	\$1,236
WSPL-C-3084	84"W x 30"D x 42" dia. Return	118	\$1,317

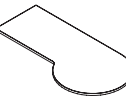

P-Top with Right Return (WSPR)			
Model Number	Description	Wgt.	List Price
WSPR-C-3072	72"W x 30"D x 42" dia. Return	101	\$1,236
WSPR-C-3084	84"W x 30"D x 42" dia. Return	118	\$1,317



Bow Front Worksurface (WSB)			
Model Number	Description	Wgt.	List Price
WSB-C-3060	30"D x 60"W	53	\$559
WSB-C-3660	36"D x 60"W	63	\$615
WSB-C-3672	36"D x 72"W	76	\$618

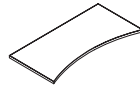

Concave Bow Front Worksurface (WSBC)			
Model Number	Description	Wgt.	List Price
WSBC-C-3060	30"D x 60"W	53	\$559
WSBC-C-3660	36"D x 60"W	58	\$615
WSBC-C-3672	36"D x 72"W	63	\$618



"D" Worksurface (WSD)			
Model Number	Description	Wgt.	List Price
WSD-C-2460	24"D x 60"W	42	\$644
WSD-C-2472	24"D x 72"W	50	\$693
WSD-C-2484	24"D x 84"W	59	\$758
WSD-C-3060	30"D x 60"W	74	\$700
WSD-C-3072	30"D x 72"W	88	\$761
WSD-C-3084	30"D x 84"W	103	\$834



Race Track (WSRT)			
Model Number	Description	Wgt.	List Price
WSRT-C-3060	30"D x 60"W	74	\$700
WSRT-C-3072	30"D x 72"W	76	\$761
WSRT-C-3660	36"D x 60"W	76	\$759
WSRT-C-3672	36"D x 72"W	78	\$828
WSRT-C-4272	42"D x 72"W	88	\$979
WSRT-C-4284	42"D x 84"W	103	\$1,094
WSRT-C-4296	42"D x 96"W	118	\$1,174
WSRT-C-4884	48"D x 84"W	118	\$1,159
WSRT-C-4896	48"D x 96"W	134	\$1,247

Worksurface description

- 1.25" 45lb. density particle board core
- High pressure laminate top
- 3mm PVC edge

TERMS & CONDITIONS

Prices: All prices are F.O.B. the factory. Prices and specifications are subject to change without notice. Prices do not include applicable taxes, special handling or installation charges. Possession of a price list is not an offer to or agreement to sell. We reserve the right to change prices without notice. We are not responsible for typographical errors. In the event a price or description is found to be incorrect, the correct information will be communicated to you when the order is received.

Credit Terms: Open account status is only granted after a completed credit application is received and approved.

Payment Terms: Terms for open account are net 30 days. Terms for orders without open account will be determined by Silver Street, Incorporated on an order-by-order basis and may require prepayment or a 50% deposit with order and the balance prepaid before shipment.

Orders: Orders must be in writing. Faxed orders are acceptable. Processing of orders will not begin until a signed acknowledgment is received.

Acknowledgments: Orders are accepted, manufactured and invoiced based on written acknowledgments issued by Silver Street, Incorporated. All orders are considered correct as acknowledged. Notify Silver Street, Incorporated immediately of any order discrepancies. Acknowledged orders may not be changed or canceled without written consent from Silver Street, Incorporated.

Changes to orders: Changes to orders already in process may be subject to a fee covering the cost to make the requested change. If a fee is necessary a written authorization of acceptance will be required. All requests for changes are subject to approval by Silver Street, Incorporated.

Cancellation of orders: All orders received by Silver Street, Incorporated are considered firm and cannot be canceled without our approval. A cancellation fee may be required based upon cost incurred by Silver Street, Incorporated prior to receipt of a cancellation request.

Returns: Returns are not accepted without a Return Goods Authorization issued by Silver Street, Incorporated. Unauthorized returns will not be accepted. Returns may be subject to a restocking fee.

Shipping Terms: All orders will be shipped F.O.B. shipping point with freight charged collect. Shipping weights listed are net.

Routing: Shipments will be routed "best way" or as specified. Instructions will be followed as closely as possible, however, Silver Street, Incorporated reserves the right to make changes due to local conditions or other circumstances.

Freight Damage: Legal title to merchandise passes to the buyer upon acceptance by the carrier. All cartons must be carefully inspected at the time of delivery. Visible damage should be noted on the delivery receipt. In the case of concealed damage, the carrier must be notified within (5) days. It is the buyer's obligation to seek recourse against the shipper.

Shortages: Shipments should be inspected upon receipt for shortages. Shortages must be reported to Silver Street, Incorporated in writing within (5) days of receipt.

Shipping Address: mtcontract®
892 Industrial Park Drive
Shelby, MI 49455

Warranty: All items manufactured by Silver Street, Incorporated, home of mtcontract® and Elements by mtcontract are guaranteed against defects for a period of five (5) years from the date of purchase. We will repair or replace, in our discretion, any defective item without cost to our customer. This is customer's sole and exclusive remedy against us. No delay in shipment or delivery shall give rise to any liability for damages whatsoever. We are not liable for defects caused by customer or any third party. Customer is not authorized to make any repairs whatsoever or to deduct any amount from the purchase price. In no event shall our liability under this warranty exceed the purchase price. In no event shall we be liable for incidental, special or consequential damages. We disclaim all other warranties, express or implied, as to any matter whatsoever, including without limitation, quality, design, performance, specifications, samples, condition, merchantability and fitness for any particular purpose. No action may be commenced for breach of the warranty more than six months after the cause of action accrues and any such action may only be brought in the county of Oceana, State of Michigan.

elements

by mediatechnologies®

is a registered trademark of Silverstreet Incorporated.

U.S. Patent # 8,434,835 B2

P-EWORKSPACEWORKSURFACE-230101