

PLEASE NOTE: The prices below are for reference only and are base models constructed of HPL work surfaces, TFL cabinets and doors with standard pulls, standard hinges and without locks. For detailed pricing please contact your local dealer or **mtcontract®**.

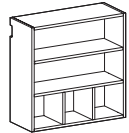

- 2 adjustable shelves

Wall Open Storage (WOS)				
Model Number	Description	Wgt.	List Price	
WOS-181424	18"W x 14"D x 24"H	36	\$358	
WOS-181430	18"W x 14"D x 30"H	39	\$360	
WOS-241424	24"W x 14"D x 24"H	44	\$363	
WOS-241430	24"W x 14"D x 30"H	47	\$371	
WOS-301424	30"W x 14"D x 24"H	52	\$393	
WOS-301430	30"W x 14"D x 30"H	55	\$400	
WOS-361424	36"W x 14"D x 24"H	59	\$430	
WOS-361430	36"W x 14"D x 30"H	63	\$446	
WOS-421424	42"W x 14"D x 24"H	73	\$500	
WOS-421430	42"W x 14"D x 30"H	78	\$511	
WOS-481424	48"W x 14"D x 24"H	82	\$502	
WOS-481430	48"W x 14"D x 30"H	86	\$511	



- 1 adjustable shelf
- 18" & 24" W units will have 2 lower cubbies
- 30" & 36" W will have 3 lower cubbies

Wall Open Storage with Cubicle Storage (WOSCB3)				
Model Number	Description	Wgt.	List Price	
WOSCB3-181424	18"W x 14"D x 24"H	36	\$384	
WOSCB3-181430	18"W x 14"D x 30"H	39	\$390	
WOSCB3-241424	24"W x 14"D x 24"H	44	\$391	
WOSCB3-241430	24"W x 14"D x 30"H	47	\$397	
WOSCB3-301424	30"W x 14"D x 24"H	55	\$424	
WOSCB3-301430	30"W x 14"D x 30"H	58	\$415	
WOSCB3-361424	36"W x 14"D x 24"H	64	\$467	
WOSCB3-361430	36"W x 14"D x 30"H	67	\$476	
WOSCB3-421424	42"W x 14"D x 24"H	78	\$536	
WOSCB3-421430	42"W x 14"D x 30"H	82	\$574	
WOSCB3-481424	48"W x 14"D x 24"H	87	\$498	
WOSCB3-481430	48"W x 14"D x 30"H	92	\$515	



- 2 adjustable shelves

Wall Cupboard Storage (WCS)				
Model Number	Description	Wgt.	List Price	
WCS-241424	24"W x 14"D x 24"H	58	\$567	
WCS-241430	24"W x 14"D x 30"H	64	\$594	
WCS-301424	30"W x 14"D x 24"H	68	\$632	
WCS-301430	30"W x 14"D x 30"H	76	\$662	
WCS-361424	36"W x 14"D x 24"H	79	\$696	
WCS-361430	36"W x 14"D x 30"H	88	\$724	
WCS-421424	42"W x 14"D x 24"H	96	\$768	
WCS-421430	42"W x 14"D x 30"H	111	\$814	
WCS-481424	48"W x 14"D x 24"H	113	\$773	
WCS-481430	48"W x 14"D x 30"H	125	\$822	



- 1 door hinged left
- 2 adjustable shelves

Wall Cupboard Storage Hinged Left (WCSL)				
Model Number	Description	Wgt.	List Price	
WCSL-181424	18"W x 14"D x 24"H	45	\$470	
WCSL-181430	18"W x 14"D x 30"H	51	\$496	
WCSL-241424	24"W x 14"D x 24"H	57	\$505	
WCSL-241430	24"W x 14"D x 30"H	64	\$594	

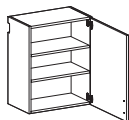

- 1 door hinged right
- 2 adjustable shelves

Wall Cupboard Storage Hinged Right (WCSR)				
Model Number	Description	Wgt.	List Price	
WCSR-181424	18"W x 14"D x 24"H	45	\$470	
WCSR-181430	18"W x 14"D x 30"H	51	\$496	
WCSR-241424	24"W x 14"D x 24"H	57	\$505	
WCSR-241430	24"W x 14"D x 30"H	64	\$594	



- 1 adjustable shelf

Wall Cupboard Storage with Open Storage (WCSOS)				
Model Number	Description	Wgt.	List Price	
WCSOS-241424	24"W x 14"D x 24"H	58	\$642	
WCSOS-241430	24"W x 14"D x 30"H	64	\$679	
WCSOS-301424	30"W x 14"D x 24"H	68	\$718	
WCSOS-301430	30"W x 14"D x 30"H	76	\$747	
WCSOS-361424	36"W x 14"D x 24"H	79	\$783	
WCSOS-361430	36"W x 14"D x 30"H	88	\$813	
WCSOS-421424	42"W x 14"D x 24"H	100	\$851	
WCSOS-421430	42"W x 14"D x 30"H	111	\$92	
WCSOS-481424	48"W x 14"D x 24"H	113	\$876	
WCSOS-481430	48"W x 14"D x 30"H	125	\$920	



- 1 adjustable shelf
- 24" W units will have 2 lower cubbies
- 30" & 36" W units will have 3 lower cubbies

Wall Cupboard Storage with Open Cubicle Storage (WCSOCB3)				
Model Number	Description	Wgt.	List Price	
WCSOCB3-241424	24"W x 14"D x 24"H	65	\$790	
WCSOCB3-241430	24"W x 14"D x 30"H	72	\$825	
WCSOCB3-301424	30"W x 14"D x 24"H	82	\$876	
WCSOCB3-301430	30"W x 14"D x 30"H	79	\$916	
WCSOCB3-361424	36"W x 14"D x 24"H	83	\$959	
WCSOCB3-361430	36"W x 14"D x 30"H	92	\$997	

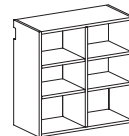

- 1 fixed partition
- 4 adjustable shelves

Wall Cubicle Storage - 6 Cubicles (WOCB6)				
Model Number	Description	Wgt.	List Price	
WOCB6-181424	18"W x 14"D x 24"H	38	\$390	
WOCB6-181430	18"W x 14"D x 30"H	41	\$414	
WOCB6-241424	24"W x 14"D x 24"H	47	\$397	
WOCB6-241430	24"W x 14"D x 30"H	50	\$424	
WOCB6-301424	30"W x 14"D x 24"H	55	\$456	
WOCB6-301430	30"W x 14"D x 30"H	58	\$478	
WOCB6-361424	36"W x 14"D x 24"H	64	\$502	
WOCB6-361430	36"W x 14"D x 30"H	67	\$520	
WOCB6-421424	42"W x 14"D x 24"H	78	\$511	
WOCB6-421430	42"W x 14"D x 30"H	82	\$536	
WOCB6-481424	48"W x 14"D x 24"H	87	\$514	
WOCB6-481430	48"W x 14"D x 30"H	92	\$537	

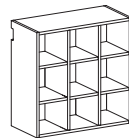

- 2 fixed vertical partitions
- 6 adjustable shelves

Wall Cubicle Storage - 9 Cubicles (WOCB9)				
Model Number	Description	Wgt.	List Price	
WOCB9-181424	18"W x 14"D x 24"H	41	\$391	
WOCB9-181430	18"W x 14"D x 30"H	44	\$415	
WOCB9-241424	24"W x 14"D x 24"H	52	\$400	
WOCB9-241430	24"W x 14"D x 30"H	55	\$425	
WOCB9-301424	30"W x 14"D x 24"H	62	\$457	
WOCB9-301430	30"W x 14"D x 30"H	65	\$480	
WOCB9-361424	36"W x 14"D x 24"H	72	\$503	
WOCB9-361430	36"W x 14"D x 30"H	75	\$525	
WOCB9-421424	42"W x 14"D x 24"H	87	\$514	
WOCB9-421430	42"W x 14"D x 30"H	92	\$537	
WOCB9-481424	48"W x 14"D x 24"H	98	\$515	
WOCB9-481430	48"W x 14"D x 30"H	103	\$537	

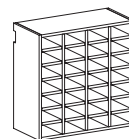

- 3 fixed vertical partitions
- 32 fixed shelves

Wall Cubicle Mail Storage (WOCBM)				
Model Number	Description	Wgt.	List Price	
WOCBM-301424	30"W x 14"D x 24"H	69	\$636	
WOCBM-301430	30"W x 14"D x 30"H	72	\$668	
WOCBM-361424	36"W x 14"D x 24"H	80	\$740	
WOCBM-361430	36"W x 14"D x 30"H	83	\$777	



- 1 fixed vertical partition
- 4 adjustable shelves

**Wall Cupboard Cubicle Storage - 6 Cubicles (WCCB6)**

Model Number	Description	Wgt.	List Price
WCCB6-181424	18"W x 14"D x 24"H	50	\$798
WCCB6-181430	18"W x 14"D x 30"H	56	\$824
WCCB6-241424	24"W x 14"D x 24"H	63	\$847
WCCB6-241430	24"W x 14"D x 30"H	70	\$88
WCCB6-301424	30"W x 14"D x 24"H	75	\$895
WCCB6-301430	30"W x 14"D x 30"H	83	\$919
WCCB6-361424	36"W x 14"D x 24"H	87	\$955
WCCB6-361430	36"W x 14"D x 30"H	96	\$998
WCCB6-421424	42"W x 14"D x 24"H	105	\$1,018
WCCB6-421430	42"W x 14"D x 30"H	116	\$1,057
WCCB6-481424	48"W x 14"D x 24"H	118	\$1,019
WCCB6-481430	48"W x 14"D x 30"H	130	\$1,058



- 2 fixed vertical partitions
- 6 adjustable shelves

**Wall Cupboard Cubicle Storage - 9 Cubicles (WCCB9)**

Model Number	Description	Wgt.	List Price
WCCB9-181424	18"W x 14"D x 24"H	54	\$802
WCCB9-181430	18"W x 14"D x 30"H	59	\$825
WCCB9-241424	24"W x 14"D x 24"H	68	\$848
WCCB9-241430	24"W x 14"D x 30"H	75	\$873
WCCB9-301424	30"W x 14"D x 24"H	82	\$900
WCCB9-301430	30"W x 14"D x 30"H	89	\$920
WCCB9-361424	36"W x 14"D x 24"H	111	\$957
WCCB9-361430	36"W x 14"D x 30"H	104	\$1,000
WCCB9-421424	42"W x 14"D x 24"H	115	\$1,019
WCCB9-421430	42"W x 14"D x 30"H	126	\$1,058
WCCB9-481424	48"W x 14"D x 24"H	129	\$1,024
WCCB9-481430	48"W x 14"D x 30"H	141	\$1,059



- 3 fixed vertical partitions
- 32 fixed shelves

**Wall Cupboard Cubicle Mail Storage (WCCBM)**

Model Number	Description	Wgt.	List Price
WCCBM-301424	30"W x 14"D x 24"H	88	\$1,289
WCCBM-301430	30"W x 14"D x 30"H	96	\$1,315
WCCBM-361424	36"W x 14"D x 24"H	103	\$1,435
WCCBM-361430	36"W x 14"D x 30"H	112	\$1,463

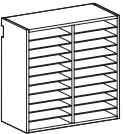

- 1 fixed vertical partition
- 20 fixed shelves

**Wall Open Folio Storage (WOF)**

Model Number	Description	Wgt.	List Price
WOF-241424	20"W x 14"D x 24"H	52	\$716
WOF-241430	20"W x 14"D x 30"H	55	\$736
WOF-301424	30"W x 14"D x 24"H	62	\$805
WOF-301430	30"W x 14"D x 30"H	65	\$830
WOF-361424	36"W x 14"D x 24"H	72	\$885
WOF-361430	36"W x 14"D x 30"H	75	\$905



- 1 fixed vertical partition
- 20 fixed shelves

**Wall Cupboard Folio Storage (WCF)**

Model Number	Description	Wgt.	List Price
WCF-241424	20"W x 14"D x 24"H	68	\$1,043
WCF-241430	20"W x 14"D x 30"H	75	\$1,086
WCF-301424	30"W x 14"D x 24"H	82	\$1,176
WCF-301430	30"W x 14"D x 30"H	89	\$1,213
WCF-361424	36"W x 14"D x 24"H	95	\$1,295
WCF-361430	36"W x 14"D x 30"H	104	\$1,331

## TERMS & CONDITIONS

**Prices:** All prices are F.O.B. the factory. Prices and specifications are subject to change without notice. Prices do not include applicable taxes, special handling or installation charges. Possession of a price list is not an offer to or agreement to sell. We reserve the right to change prices without notice. We are not responsible for typographical errors. In the event a price or description is found to be incorrect, the correct information will be communicated to you when the order is received.

**Credit Terms:** Open account status is only granted after a completed credit application is received and approved.

**Payment Terms:** Terms for open account are net 30 days. Terms for orders without open account will be determined by Silver Street, Incorporated on an order-by-order basis and may require prepayment or a 50% deposit with order and the balance prepaid before shipment.

**Orders:** Orders must be in writing. Faxed orders are acceptable. Processing of orders will not begin until a signed acknowledgment is received.

**Acknowledgments:** Orders are accepted, manufactured and invoiced based on written acknowledgments issued by Silver Street, Incorporated. All orders are considered correct as acknowledged. Notify Silver Street, Incorporated immediately of any order discrepancies. Acknowledged orders may not be changed or canceled without written consent from Silver Street, Incorporated.

**Changes to orders:** Changes to orders already in process may be subject to a fee covering the cost to make the requested change. If a fee is necessary a written authorization of acceptance will be required. All requests for changes are subject to approval by Silver Street, Incorporated.

**Cancellation of orders:** All orders received by Silver Street, Incorporated are considered firm and cannot be canceled without our approval. A cancellation fee may be required based upon cost incurred by Silver Street, Incorporated prior to receipt of a cancellation request.

**Returns:** Returns are not accepted without a Return Goods Authorization issued by Silver Street, Incorporated. Unauthorized returns will not be accepted. Returns may be subject to a restocking fee.

**Shipping Terms:** All orders will be shipped F.O.B. shipping point with freight charged collect. Shipping weights listed are net.

**Routing:** Shipments will be routed "best way" or as specified. Instructions will be followed as closely as possible, however, Silver Street, Incorporated reserves the right to make changes due to local conditions or other circumstances.

**Freight Damage:** Legal title to merchandise passes to the buyer upon acceptance by the carrier. All cartons must be carefully inspected at the time of delivery. Visible damage should be noted on the delivery receipt. In the case of concealed damage, the carrier must be notified within (5) days. It is the buyer's obligation to seek recourse against the shipper.

**Shortages:** Shipments should be inspected upon receipt for shortages. Shortages must be reported to Silver Street, Incorporated in writing within (5) days of receipt.

**Shipping Address:**  
**mediatechnologies®**  
 A division of Silver Street, Inc.  
 892 Industrial Park Drive  
 Shelby, MI 49455

**Warranty:** All items manufactured by Silver Street, Incorporated, home of mediatechnologies® and Elements by mediatechnologies are guaranteed against defects for a period of five (5) years from the date of purchase. We will repair or replace, in our discretion, any defective item without cost to our customer. This is customer's sole and exclusive remedy against us. No delay in shipment or delivery shall give rise to any liability for damages whatsoever. We are not liable for defects caused by customer or any third party. Customer is not authorized to make any repairs whatsoever or to deduct any amount from the purchase price. In no event shall our liability under this warranty exceed the purchase price. In no event shall we be liable for incidental, special or consequential damages. We disclaim all other warranties, express or implied, as to any matter whatsoever, including without limitation, quality, design, performance, specifications, samples, condition, merchantability and fitness for any particular purpose. No action may be commenced for breach of the warranty more than six months after the cause of action accrues and any such action may only be brought in the county of Oceana, State of Michigan.

# elements

by mediatechnologies®

is a registered trademark of Silverstreet Incorporated.



U.S. Patent # 8,434,835 B2

P-ELEMENTSWALL-191210